

**DESCRIPTION: MALE CENTRONICS BACKSHELL KIT**

**BACKSHELL KIT INCLUDES:**

- (1) SOLDER CUP CONNECTOR
- (1) BACKSHELL WITH STRAIN RELIEF, (2) SCREWS
- (1) FACE PLATE
- (1) RUBBER GROMMET

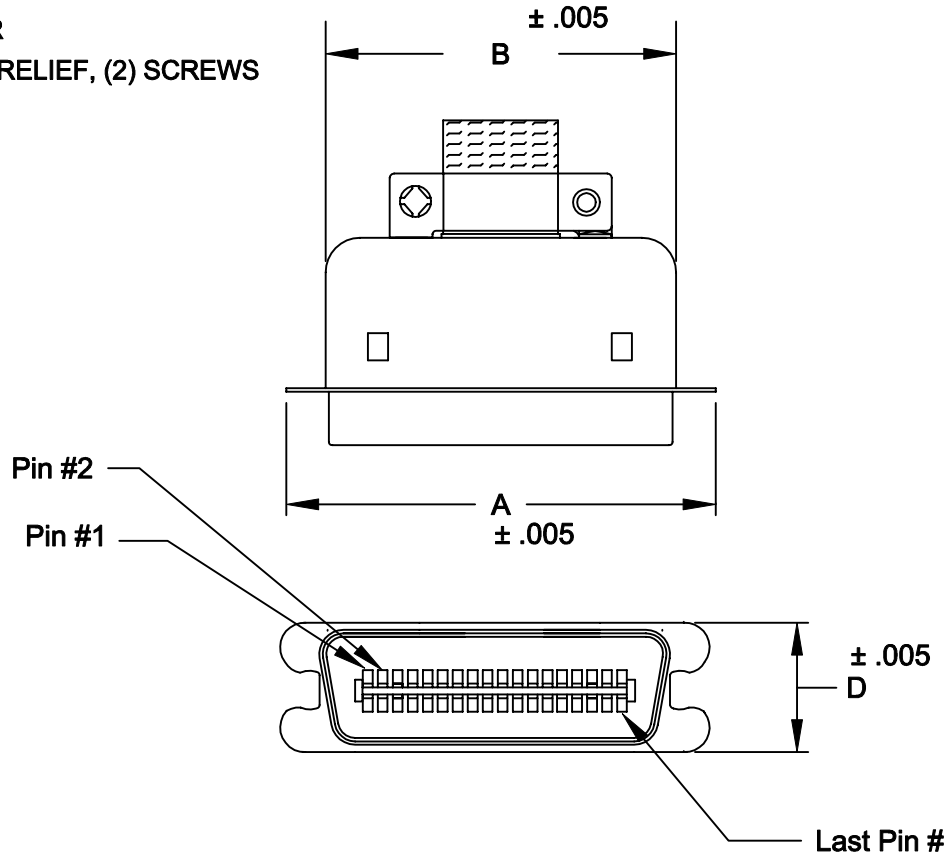

110-XXX-103-001

SERIES \_\_\_\_\_  
 POSITIONS \_\_\_\_\_  
 014 \_\_\_\_\_  
 024 \_\_\_\_\_  
 036 \_\_\_\_\_  
 050 \_\_\_\_\_  
 GENDER \_\_\_\_\_  
 1 = MALE \_\_\_\_\_  
 2 = FEMALE \_\_\_\_\_  
 TERMINATION \_\_\_\_\_  
 0 = SOLDER CUP \_\_\_\_\_  
 SHELL PLATING \_\_\_\_\_  
 3 = NICKEL \_\_\_\_\_  
 HARDWARE OPTIONS \_\_\_\_\_  
 00 = NOT AVAILABLE \_\_\_\_\_  
 PLATING OPTIONS \_\_\_\_\_  
 1 = GOLD FLASH \_\_\_\_\_

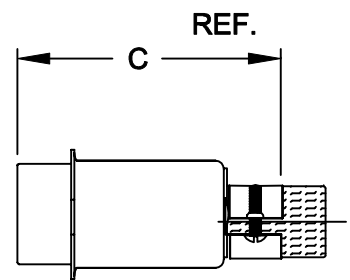

	A	B	C	D
014	1.496	1.132	1.572	.622
	38.00	29.75	40.06	15.80
024	1.919	1.593	1.560	.622
	48.75	40.45	39.61	15.80
036	2.431	2.090	1.624	.622
	61.76	53.10	41.25	15.80
050	3.026	2.677	1.730	.622
	76.86	68.00	43.95	15.80

**MATERIALS:**

INSULATOR: GLASS-FILLED THERMOPLASTIC  
 UL RATED 94V-0

CONTACTS: COPPER ALLOY  
 ELECTRICALS:

CONTACT CURRENT RATING: 5 AMPS

DIELECTRIC WITHSTANDING VOLTAGE: AC 1200 R.M.S.

INSULATION RESISTANCE: 1000 mohms MINIMUM AT 500V DC

CONTACT RESISTANCE: 30 mOHMS MAXIMUM

OPERATING TEMPERATURE: -55°C TO +125°C



THESE DRAWINGS AND SPECIFICATIONS ARE THE PROPERTY OF NorComp AND SHALL NOT BE REPRODUCED, COPIED OR USED AS THE BASIS FOR THE MANUFACTURE OF SALE OF APPARATUS WITHOUT WRITTEN PERMISSION.

DRAWN: WAYNE ROBBINS  
 DATE: 9-17-98

CHECKED: \_\_\_\_\_  
 DATE: \_\_\_\_\_

**NorComp**

SCALE: 1:1 SHEET 1 OF 1 REV 2

DWG NO. 110-XXX-103-001